

**DETERMINATION OF AN APPLICATION FOR  
A PREMISES LICENCE  
71 HIGH STREET, ALDERSHOT, HAMPSHIRE GU11 1BZ**

**1.1 INTRODUCTION**

- 1.2 This report concerns an application for a premises licence made under section 17 of the Licensing Act 2003 (the 'Act'). A representation has been received in respect of the application and invokes a statutory requirement to hold a hearing with members.
- 1.3 The report provides details of, and background to the application, and should be read in conjunction with the Council's licensing policy and Secretary of State's guidance. This, together with information obtained at the hearing should be used to determine the application.

**2.1 BACKGROUND**

- 2.2 An application for a premises licence was submitted on 16<sup>th</sup> November 2022 by Mits Food Ltd T/A Milano Pizza in respect of a premises known as 71 High Street, Aldershot, Hampshire GU11 1BZ. A map of the area showing the general location of the premises is given at **appendix A**.

**2.3 Nature of the application**

- 2.4 The application seeks the provision of late-night refreshment from 23:00pm to 00:00(midnight) on Mondays to Wednesdays and 23:00pm to 02:00am on Thursdays to Sundays. A copy of the application form is given at **appendix B**.

**2.6 Advertising of the application**

- 2.7 I can confirm that each responsible authority (as specified in the Act) has received a copy of the application. Similarly, the application was advertised by the applicant in accordance with the requirements of the legislation both at the premises and in a local newspaper. The last date for representations was given as the 17<sup>th</sup> January 2023.
- 2.8 The original last date for representations was the 14<sup>th</sup> December 2022, however due to an error with the newspaper, the advert was not placed in the required time and so the consultation period had to start again.

### **3.0 REPRESENTATION(S)**

3.1 Eight representations were received in respect of the application from members of the public. A copy of the representations is given at **appendix C1 – C8** respectively.

### **3.3 Relevance of Representation(s)**

3.4 To be eligible to be considered, the Act requires a(ny) representation(s) to be '*relevant*'. A '*relevant representation*' is one that has been made by a responsible authority, any other person, a body representing such persons or a Member of the relevant licensing authority (i.e. elected councillors). Similarly, representations must not be frivolous or vexatious and must be about the likely effect of the grant of the licence on the promotion of the licensing objectives.

The licensing objectives are defined in the Act and include -

- (a) the prevention of crime and disorder;
- (b) ensuring public safety;
- (c) the prevention of public nuisance; and
- (d) the protection of children from harm.

Against the above criteria, the representations are considered relevant in this case, as they concern the licensing objective the prevention of crime and disorder.

### **4.1 OTHER DATA PROTECTION ISSUES**

4.2 In accordance with data protection requirements, any personal details, addresses, contact details and/or signatures submitted on any application, representation or other relevant document etc. have been redacted.

### **5.1 DETERMINATION**

5.2 Further to the receipt of the relevant representation and, in accordance with the Act and the Council's scheme of delegation, the Sub-Committee is asked to determine the application.

### **6.1 RELEVANT CONSIDERATIONS**

#### **6.2 Licensing Objectives**

6.3 In considering the application the licensing authority must have regard to the promotion of the licensing objectives given at paragraph 3.4 of this report.

#### **6.4 Licensing Policy and Secretary of States Guidance**

6.5 The licensing authority must also have regard to its statement of licensing policy and any guidance issued by the Secretary of State under section 182 of the Act.

6.6 Details of the parts of the policy and guidance that may be relevant to this application are given in **appendix D** to this report.

#### **7.1 OPTIONS**

7.2 In determining this application, the Sub-Committee may take any of the following steps as it considers appropriate for the promotion of the licensing objectives; namely -

- (a) to grant the licence as applied for\*; or
- (b) to exclude from the scope of the licence any of the licensable activities to which the application relates\*; and/or
- (c) to reject the whole or part of the application.

*\* Subject to any relevant mandatory conditions, amendments agreed by the applicant and/or such other conditions that are consistent with the operating schedule which, with the exception of mandatory conditions, may be modified (which may include the alteration or omission of a condition or the addition of any new condition(s)) to such extent as may be necessary to promote the licensing objectives.*

#### **8.1 RECOMMENDATION(S)**

8.2 The Sub-Committee is asked to determine the application having regard to -

- (a) the contents of this report;
- (b) any additional information obtained from the hearing;
- (c) the Council's licensing policy;
- (d) guidance issued by the Secretary of State; and
- (e) the promotion of the licensing objectives.

**AIMEE VOSSER**  
**Licensing Officer**  
**Operational Services**  
*licensing@rushmoor.gov.uk*

---

**Public Documents:**

- 1) **HMSO (2003)**, The Licensing Act 2003
- 2) **Home Office (December 2022)**, Guidance issued under Section 182 of the Licensing Act 2003

**Contact:**

Aimee Vosser, Licensing Officer (01252 398131)

**Appendices:**

- Appendix A - Map of the area (page 5)
- Appendix B - Application for a premises licence (pages 7 - 26)
- Appendix C1–C8- Representations - Members of the Public (pages 27 – 34)
- Appendix D - Policy and Guidance – Relevant considerations (Page 35)

# APPENDIX A

## MAP SHOWING LOCATION OF PREMISES 71 HIGH STREET, ALDERSHOT, HAMPSHIRE GU11 1BZ

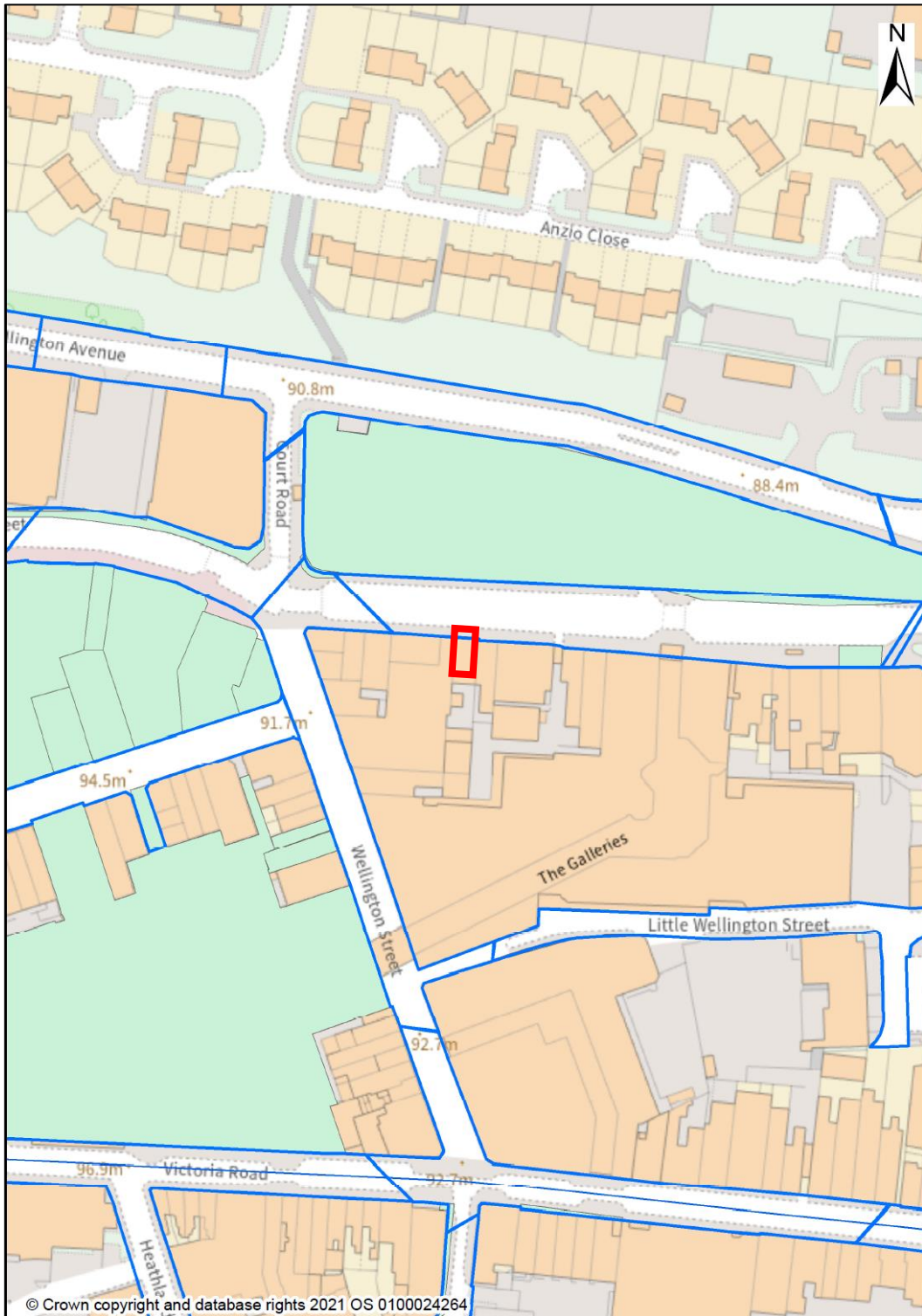



# APPENDIX B

## APPLICATION FOR A NEW PREMISES LICENCE 71 HIGH STREET, ALDERSHOT, HAMPSHIRE GU11 1BZ

### Application for a premises licence to be granted under the Licensing Act 2003

Please read the following instructions first

Before completing this form please read the guidance notes at the end of the form. If you are completing this form by hand please write legibly in block capitals. In all cases ensure that your answers are inside the boxes and written in black ink. Use additional sheets if necessary.

You may wish to keep a copy of the completed form for your records.

**[REDACTED]**  
(Insert name(s) of applicant)

apply for a premises licence under section 17 of the Licensing Act 2003 for the premises described in Part 1 below (the premises) and I/we are making this application to you as the relevant licensing authority in accordance with section 12 of the Licensing Act 2003

#### Part 1 – Premises details

71 High Street			
Post town	Aldershot	Postcode	GU11 1BY

Telephone number at premises (if any)	01252334581
Non-domestic rateable value of premises	£ 4300

#### Part 2 - Applicant details

Please state whether you are applying for a premises licence as appropriate Please tick as appropriate

a)	an individual or individuals *		please complete section (A)
b)	a person other than an individual *		
	i as a limited company/limited liability partnership	x	please complete section (B)
	ii as a partnership (other than limited liability)		please complete section (B)
	iii as an unincorporated association or		please complete section (B)
	iv other (for example a statutory corporation)		please complete section (B)
c)	a recognised club		please complete section (B)
d)	a charity		please complete section (B)

e)	the proprietor of an educational establishment		please complete section (B)
f)	a health service body		please complete section (B)
g)	a person who is registered under Part 2 of the Care Standards Act 2000 (c14) in respect of an independent hospital in Wales		please complete section (B)
ga)	a person who is registered under Chapter 2 of Part 1 of the Health and Social Care Act 2008 (within the meaning of that Part) in an independent hospital in England		please complete section (B)
h)	the chief officer of police of a police force in England and Wales		please complete section (B)

\* If you are applying as a person described in (a) or (b) please confirm (by ticking yes to one box below):

- I am carrying on or proposing to carry on a business which involves the use of the premises for licensable activities; or
- I am making the application pursuant to a
- statutory function or
- a function discharged by virtue of Her Majesty's prerogative

**(A) Individual applicants (fill in as applicable)**

Mr	Mrs	Miss	Ms	Other Title (for example, Rev)	
<b>Surname</b>			<b>First names</b>		
<b>Date of birth</b>		I am 18 years old or over		Please tick yes	
<b>Nationality</b>					
Current residential address if different from premises address					
Post town				Postcode	
<b>Daytime contact telephone number</b>					
<b>E-mail address (optional)</b>					
Where applicable (if demonstrating a right to work via the Home Office online right to work checking service), the 'share code' provided to the applicant by that service (please see note 15 for information)					

**Second individual applicant (if applicable)**



Mr	Mrs	Miss	Ms	Other Title (for example, Rev)	
Surname			First names		
Date of birth over		I am 18 years old or		Please tick yes	
Nationality					
Current residential address if different from premises address					
Post town				Postcode	
Daytime contact telephone number					
E-mail address (optional)					
Where applicable (if demonstrating a right to work via the Home Office online right to work checking service), the 'share code' provided to the applicant by that service: (please see note 15 for information)					

**(B) Other applicants**

Please provide name and registered address of applicant in full. Where appropriate please give any registered number. In the case of a partnership or other joint venture (other than a body corporate), please give the name and address of each party concerned.

Name Mits Food ltd T/A Milano Pizza
Address 71 High Street, Aldershot, GU11 1BY
Registered number (where applicable) <b>13563762</b>
Description of applicant (for example, partnership, company, unincorporated association etc.) Company
Telephone number (if any) 01252334581

E-mail address (optional) milanopizzas@hotmail.com

**Part 3 Operating Schedule**

When do you want the premises licence to start?

DD	MM	YYYY
0	9	112022

If you wish the licence to be valid only for a limited period, when do you want it to end?

DD	MM	YYYY

Please give a general description of the premises (please read guidance note 1)

If 5,000 or more people are expected to attend the premises at any one time, please state the number expected to attend.

What licensable activities do you intend to carry on from the premises?

(please see sections 1 and 14 and Schedules 1 and 2 to the Licensing Act 2003)

Provision of regulated entertainment (please read guidance note 2)	Please tick all that apply
a) plays (if ticking yes, fill in box A)	
b) films (if ticking yes, fill in box B)	
c) indoor sporting events (if ticking yes, fill in box C)	
d) boxing or wrestling entertainment (if ticking yes, fill in box D)	
e) live music (if ticking yes, fill in box E)	
f) recorded music (if ticking yes, fill in box F)	
g) performances of dance (if ticking yes, fill in box G)	
h) anything of a similar description to that falling within (e), (f) or (g) (if ticking yes, fill in box H)	

<b>Provision of late night refreshment</b> (if ticking yes, fill in box I)	✓
--	---

<b>Supply of alcohol</b> (if ticking yes, fill in box J)	
--	--

In all cases complete boxes K, L and M

**A**

Plays Standard days and timings (please read guidance note 7)			<u>Will the performance of a play take place indoors or outdoors or both – please tick</u> (please read guidance note 3)	Indoors	
Day	Start	Finish		Outdoors	
Mon			<u>Please give further details here</u> (please read guidance note 4)	Both	
Tue					
Wed			<u>State any seasonal variations for performing plays</u> (please read guidance note 5)		
Thur					
Fri			<u>Non standard timings. Where you intend to use the premises for the performance of plays at different times to those listed in the column on the left, please list</u> (please read guidance note 6)		
Sat					
Sun					

**B**

Films Standard days and timings (please read guidance note 7)			Will the exhibition of films take place <u>indoors or outdoors or both – please tick</u> (please read guidance note 3)	Indoors	
Day				Outdoors	
Start	Finish			Both	
Mon			<b><u>Please give further details here</u></b> (please read guidance note 4)		
Tue					
Wed			<b><u>State any seasonal variations for the exhibition of films</u></b> (please read guidance note 5)		
Thur					
Fri			<b><u>Non standard timings. Where you intend to use the premises for the exhibition of films at different times to those listed in the column on the left, please list</u></b> (please read guidance note 6)		
Sat					
Sun					

**C**

<b>Indoor sporting events</b> Standard days and timings (please read guidance note 7)			Please give further details (please read guidance note 4)
Day	Start	Finish	
Mon			State any seasonal variations for indoor sporting events (please read guidance note 5)
Tue			
Wed			
Thur			Non standard timings. Where you intend to use the premises for indoor sporting events at different times to those listed in the column on the left, please list (please read guidance note 6)
Fri			
Sat			
Sun			

**D**

Boxing or wrestling entertainments Standard days and timings (please read guidance note 7)			Will the boxing or wrestling entertainment take place indoors or outdoors or both – please tick (please read guidance note 3)	Indoors	
Day	Start	Finish		Outdoors	
Mon			Please give further details here (please read guidance note 4)	Both	
Tue					
Wed			State any seasonal variations for boxing or wrestling entertainment (please read guidance note 5)		
Thur					
Fri			Non standard timings. Where you intend to use the premises for boxing or wrestling entertainment at different times to those listed in the column on the left, please list (please read guidance note 6)		
Sat					
Sun					

**E**

Live music Standard days and timings (please read guidance note 7)			Will the performance of live music take <u>place indoors or outdoors or both</u> – please tick (please read guidance note 3)	Indoors	
Day	Start	Finish		Outdoors	
Mon			Please give further details here (please read guidance note 4)	Both	
Tue					
Wed			State any seasonal variations for the performance of live music (please read guidance note 5)		
Thur					
Fri			Non standard timings. Where you intend to use the premises for the performance of live music at different times to those listed in the column on the left, please list (please read guidance note 6)		
Sat					
Sun					



**F**

Recorded music Standard days and timings (please read guidance note 7)			Will the playing of recorded music take place indoors or outdoors or both – please tick (please read guidance note 3)	Indoors	
Day	Start	Finish		Outdoors	
Mon			Please give further details here (please read guidance note 4)	Both	
Tue					
Wed			State any seasonal variations for the playing of recorded music (please read guidance note 5)		
Thur					
Fri			Non standard timings. Where you intend to use the premises for the playing of recorded music at different times to those listed in the column on the left, please list (please read guidance note 6)		
Sat					
Sun					

**G**

Performances of dance Standard days and timings (please read guidance note 7)			Will the performance of dance take place indoors or outdoors or both – please tick (please read guidance note 3)	Indoors	
Day	Start	Finish		Outdoors	
Mon			Please give further details here (please read guidance note 4)	Both	
Tue					
Wed			State any seasonal variations for the performance of dance (please read guidance note 5)		
Thur					
Fri			Non standard timings. Where you intend to use the premises for the performance of dance at different times to those listed in the column on the left, please list (please read guidance note 6)		
Sat					
Sun					

**H**

<b>Anything of a similar description to that falling within (e), (f) or (g)</b> Standard days and timings (please read guidance note 7)			Please give a description of the type of entertainment you will be providing		
Day	Start	Finish	<u>Will this entertainment take place indoors or outdoors or both – please tick</u> (please read guidance note 3)	Indoors	
Mon				Outdoors	
				Both	
Tue			<u>Please give further details here</u> (please read guidance note 4)		
Wed					
Thur			<u>State any seasonal variations for entertainment of a similar description to that falling within (e), (f) or (g)</u> (please read guidance note 5)		
Fri					
Sat			<u>Non standard timings. Where you intend to use the premises for the entertainment of a similar description to that falling within (e), (f) or (g) at different times to those listed in the column on the left, please list</u> (please read guidance note 6)		
Sun					

I

Late night refreshment Standard days and timings (please read guidance note 7)			Will the provision of late night refreshment take place indoors or outdoors or both – please tick (please read guidance note 3)	Indoors	✓
				Outdoors	
Day	Start	Finish		Both	
Mon	11:00	00:00	<b><u>Please give further details here</u></b> (please read guidance note 4)		
Tue	11:00	00:00	<b><u>State any seasonal variations for the provision of late night refreshment</u></b> (please read guidance note 5)		
Wed	11:00	00:00	<b><u>Non standard timings. Where you intend to use the premises for the provision of late night refreshment at different times, to those listed in the column on the left, please list</u></b> (please read guidance note 6)		
Thur	11:00	02:00			
Fri	11:00	02:00			
Sat	11:00	02:00			
Sun	11:00	02:00			

**J**

Supply of alcohol Standard days and timings (please read guidance note 7)			Will the supply of alcohol be for <u>consumption – please tick</u> (please read guidance note 8)	On the premises	
Day	Start	Finish		Off the premises	
Mon			<b>State any seasonal variations for the supply of alcohol</b> (please read guidance note 5)	Both	
Tue					
Wed					
Thur			<b>Non standard timings. Where you intend to use the premises for the supply of alcohol at different times to those listed in the column on the left, please list</b> (please read guidance note 6)		
Fri					
Sat					
Sun					

State the name and details of the individual whom you wish to specify on the licence as designated premises supervisor (Please see declaration about the entitlement to work in the checklist at the end of the form):

Name	
Date of birth	
Address	
Postcode	
Personal licence number (if known)	
Issuing licensing authority (if known)	

**K**

Please highlight any adult entertainment or services, activities, other entertainment or matters ancillary to the use of the premises that may give rise to concern in respect of children (please read guidance note 9).

N/A

**L**

Hours premises are open to the public Standard days and timings (please read guidance note 7)			State any seasonal variations (please read guidance note 5)
Day	Start	Finish	
Mon	11:00	00:00	<p><u>Non standard timings. Where you intend the premises to be open to the public at different times from those listed in the column on the left, please list</u> (please read guidance note 6)</p>
Tue	11:00	00:00	
Wed	11:00	00:00	
Thur	11:00	02:00	
Fri	11:00	02:00	
Sat	11:00	02:00	
Sun	11:00	02:00	

**M**

Describe the steps you intend to take to promote the four licensing objectives:

**a) General – all four licensing objectives (b, c, d and e) (please read guidance note 10)**

- In the absence of adequate daylight, artificial lighting in any area accessible to the public shall be fully operational whilst the public are present.
- All external doors and windows shall be maintained in good order.
- All the rubbish produced by the premises shall be stored securely in a designated area or in a bin with a tight fitting and lockable lid.
- A sufficient number of suitable receptacles must be located in appropriate locations for the depositing of waste materials such as food wrappings, drinks containers, etc. by customers.
- No fumes, steam or odours shall be emitted from the licensed premises so as to cause a nuisance to any persons living or carrying on business in the area where the premises are situated.
- Ventilation equipment will be regularly cleaned and maintained to control the levels of odour generated by the premises.
- When issues are identified approaches will be made to patrons, who will be asked not to stand around talking in the street outside the premises or any car park; and asked to leave the vicinity as quickly and quietly as possible.

**b) The prevention of crime and disorder**

**c) Public safety**

**d) The prevention of public nuisance**

**e) The protection of children from harm**

--

**Checklist:**

**Please tick to indicate agreement**

•	I have made or enclosed payment of the fee.	✓
•	I have enclosed the plan of the premises.	✓
•	I have sent copies of this application and the plan to responsible authorities and others where applicable.	
•	I have enclosed the consent form completed by the individual I wish to be designated premises supervisor, if applicable.	
•	I understand that I must now advertise my application.	✓
•	I understand that if I do not comply with the above requirements my application will be rejected.	✓
•	[Applicable to all individual applicants, including those in a partnership which is not a limited liability partnership, but not companies or limited liability partnerships] I have included documents demonstrating my entitlement to work in the United Kingdom or my share code issued by the Home Office online right to work checking service (please read note 15).	

It is an offence, under Section 158 of the Licensing Act 2003, to make a false statement in or in connection with this application. Those who make a false statement may be liable on summary conviction to a fine of any amount.

It is an offence under Section 24b of the Immigration Act 1971 for a person to work when they know, or have reasonable cause to believe, that they are disqualified from doing so by reason of their immigration status. Those who employ an adult without leave or who is subject to conditions as to employment will be liable to a civil penalty under section 15 of the Immigration, Asylum and Nationality Act 2006 and pursuant to Section 21 of the same act, will be committing an offence where they do so in the knowledge, or with reasonable cause to believe, that the employee is disqualified.

**Part 4 – Signatures** (please read guidance note 11)

**Signature of applicant or applicant’s solicitor or other duly authorised agent** (see guidance note 12). **If signing on behalf of the applicant, please state in what capacity.**

<b>Declaration</b>	<ul style="list-style-type: none"> <li>• [Applicable to individual applicants only, including those in a partnership which is not a limited liability partnership] I understand I am not entitled to be issued with a licence if I do not have the entitlement to live and work in the UK (or if I am subject to a condition preventing me from doing work relating to the carrying on of a licensable activity) and that my licence will become invalid if I cease to be entitled to live and work in the UK (please read guidance note 15).</li> </ul>
--------------------	--



	<ul style="list-style-type: none"> <li>The DPS named in this application form is entitled to work in the UK (and is not subject to conditions preventing him or her from doing work relating to a licensable activity) and I have seen a copy of his or her proof of entitlement to work, or have conducted an online right to work check using the Home Office online right to work checking service which confirmed their right to work (please see note 15)</li> </ul>
Signature	██████████
Date	15/11/2022
Capacity	

For joint applications, signature of 2<sup>nd</sup> applicant or 2<sup>nd</sup> applicant's solicitor or other authorised agent (please read guidance note 13). If signing on behalf of the applicant, please state in what capacity.

Signature	
Date	
Capacity	

Contact name (where not previously given) and postal address for correspondence associated with this application (please read guidance note 14)

Post town		Postcode	
Telephone number (if any)			
If you would prefer us to correspond with you by e-mail, your e-mail address (optional)			

**Notes for Guidance**

- Describe the premises, for example the type of premises, its general situation and layout and any other information which could be relevant to the licensing objectives. Where your application includes off-supplies of alcohol and you intend to provide a place for consumption of these off-supplies, you must

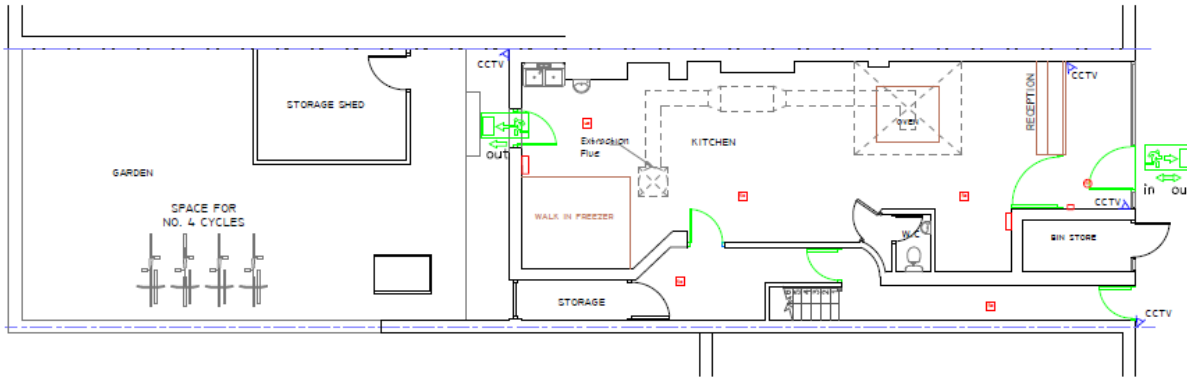

EXISTING FLOOR PLAN

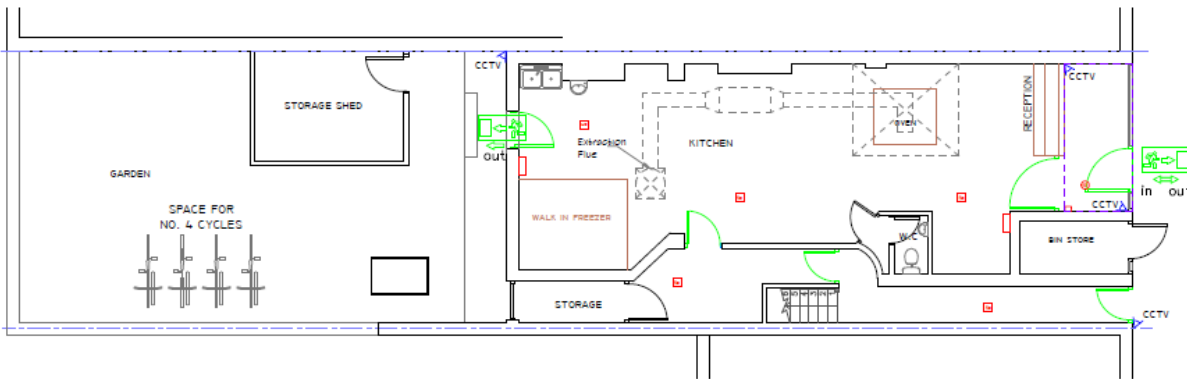

PROPOSED FLOOR PLAN

- Key**
- late night refreshment areas
  - fixed structures including furniture
  - entrances, exits and escape routes
  - fire safety and other safety equipment
    - CO2 and Foam fire extinguishers
    - fire alarm system
  - sounder
  - ◀ cctv
  - smoke detector
  - heat detector

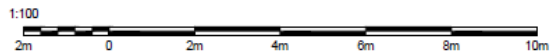

<b>Ref.</b>	<b>Revision</b>	<b>Date</b>	<b>By</b>	<b>CTF Associates</b> Chartered Architects Design Consultants	NOTES: Drawn: S.Y. Checked: S.Y. Date: 15-11-2022 Project: 71 High Street, Aldershot, Hampshire, GU11 1BY. Scale: A3 @ 1:100 Date: 15-11-2022 Drawn by: S.Y. Job number: 1238 Drawing number: 1 Revision:
ALL DIMENSIONS TO BE CHECKED ON SITE ONLY TO BE SCALED FOR PLANNING AND BUILDING REGULATIONS					
Client: Mr Muhammad Iran					

# APPENDIX C1

## REPRESENTATIONS 71 HIGH STREET, ALDERSHOT, HAMPSHIRE GU11 1BZ

From: publicaccess@rushmoor.gov.uk <publicaccess@rushmoor.gov.uk>  
Sent: 22 November 2022 23:32  
To: Rushmoor Council Licensing <Licensing@rushmoor.gov.uk>  
Subject: Comments for Licensing Application 22/01169/LAPRE

### Comments summary

Dear Sir/Madam,

Licensing Application comments have been made. A summary of the comments is provided below.

Comments were submitted at 22/11/2022 11:32 PM from [REDACTED].

#### Application Summary

Address:	71 High Street Aldershot Hampshire GU11 1BZ
Proposal:	Premises Licence
Case Officer:	Aimee Vosser

[Click for further information](#)

#### Customer Details

Name:	[REDACTED]
Email:	[REDACTED]
Address:	[REDACTED]

#### Comments Details

1

Commenter Type:	[REDACTED]
Stance:	Customer objects to the Licensing Application
Reasons for comment:	
Comments:	22/11/2022 11:32 PM Hi there are lots of shops open till late and giving chance to open this I think it will create more crime to town and unsafe for neighbours mostly in weekend

Kind regards

## APPENDIX C2

**From:** publicaccess@rushmoor.gov.uk <publicaccess@rushmoor.gov.uk>  
**Sent:** 17 November 2022 10:38  
**To:** Rushmoor Council Licensing <Licensing@rushmoor.gov.uk>  
**Subject:** Comments for Licensing Application 22/01169/LAPRE

### Comments summary

Dear Sir/Madam,

Licensing Application comments have been made. A summary of the comments is provided below.

Comments were submitted at 17/11/2022 10:37 AM from [REDACTED].

#### Application Summary

Address: 71 High Street Aldershot Hampshire GU11 1BZ

Proposal: Premises Licence

Case Officer: Aimee Vosser

[Click for further information](#)

#### Customer Details

Name: [REDACTED]

Email: [REDACTED]

Address: [REDACTED]

#### Comments Details

1

Commenter Type: Other

Stance: Customer objects to the Licensing Application

Reasons for comment:

Comments: 17/11/2022 10:37 AM By authorising this business late night trading hours, as a member of public I am concerned for the public nuisance and also an increase in crime activities on ALDERSHOT High Street, especially when the new students accommodations will be ready in the town center.

Kind regards

# APPENDIX C3

**Aimee Vosser**

---

**From:** publicaccess@rushmoor.gov.uk  
**Sent:** 02 December 2022 20:13  
**To:** Rushmoor Council Licensing  
**Subject:** Comments for Licensing Application 22/01169/LAPRE

## Comments summary

Dear Sir/Madam,

Licensing Application comments have been made. A summary of the comments is provided below.

Comments were submitted at 02/12/2022 8:13 PM from [REDACTED].

### Application Summary

Address: 71 High Street Aldershot Hampshire GU11 1BZ

---

Proposal: Premises Licence

---

Case Officer: Aimee Vosser

---

[Click for further information](#)

### Customer Details

Name: [REDACTED]

---

Email: [REDACTED]

---

Address: [REDACTED]

---

### Comments Details

Commenter Type: Other

---

Stance: Customer objects to the Licensing Application

---

Reasons for comment:

Comments: 02/12/2022 8:13 PM Hi I was walking through high street and seen that mialno pizza will be opening till 2:00 am . I think it will create lots of noise and and fighting will increase during weekend  
Thank you

---

Kind regards

# APPENDIX C4

**Aimee Vosser**

---

**From:** publicaccess@rushmoor.gov.uk  
**Sent:** 02 December 2022 20:18  
**To:** Rushmoor Council Licensing  
**Subject:** Comments for Licensing Application 22/01169/LAPRE

## Comments summary

Dear Sir/Madam,

Licensing Application comments have been made. A summary of the comments is provided below.

Comments were submitted at 02/12/2022 8:17 PM from [REDACTED]

### Application Summary

Address:	71 High Street Aldershot Hampshire GU11 1BZ
Proposal:	Premises Licence
Case Officer:	Aimee Vosser

[Click for further information](#)

### Customer Details

Name:	[REDACTED]
Email:	[REDACTED]
Address:	[REDACTED]

### Comments Details

Commenter Type:	Other
Stance:	Customer objects to the Licensing Application
Reasons for comment:	
Comments:	02/12/2022 8:17 PM I believe there are enough shop and already open. And lots of noise at the weekend .mostly weekends it will attract more crime and fights around town .

Kind regards

## APPENDIX C5

**From:** publicaccess@rushmoor.gov.uk <publicaccess@rushmoor.gov.uk>  
**Sent:** 19 November 2022 01:02  
**To:** Rushmoor Council Licensing <Licensing@rushmoor.gov.uk>  
**Subject:** Comments for Licensing Application 22/01169/LAPRE

### Comments summary

Dear Sir/Madam,

Licensing Application comments have been made. A summary of the comments is provided below.

Comments were submitted at 19/11/2022 1:02 AM from [REDACTED].

#### Application Summary

Address: 71 High Street Aldershot Hampshire GU11 1BZ

Proposal: Premises Licence

Case Officer: Aimee Vosser

[Click for further information](#)

#### Customer Details

Name: [REDACTED]

Email: [REDACTED]

Address: [REDACTED]

#### Comments Details

1

Commenter Type: Other

Stance: Customer objects to the Licensing Application

Reasons for comment:

Comments: 19/11/2022 1:02 AM "Having this business opened until 2am especially in the weekend will only make the high street a dangerous place for public. I strongly believe that are enough business in ALDERSHOT operating until 2 am, we don't need another one. That will only make the town center noisy and unsafe for the public."

Kind regards

## APPENDIX C6

**From:** publicaccess@rushmoor.gov.uk <publicaccess@rushmoor.gov.uk>  
**Sent:** 17 November 2022 21:56  
**To:** Rushmoor Council Licensing <Licensing@rushmoor.gov.uk>  
**Subject:** Comments for Licensing Application 22/01169/LAPRE

### Comments summary

Dear Sir/Madam,

Licensing Application comments have been made. A summary of the comments is provided below.

Comments were submitted at 17/11/2022 9:56 PM from [REDACTED].

#### Application Summary

Address: 71 High Street Aldershot Hampshire GU11 1BZ

Proposal: Premises Licence

Case Officer: Aimee Vosser

[Click for further information](#)

#### Customer Details

Name: [REDACTED]

Email: [REDACTED]

Address: [REDACTED]

#### Comments Details

1

Committer Type: Neighbour

Stance: Customer objects to the Licensing Application

Reasons for comment:

Comments: 17/11/2022 9:56 PM "I am against this proposed opening hours because I am concerned of increased crime activities on the high street especially around the multi-storey car park that is opposite this location." And new building that they are making now

Kind regards



## APPENDIX C7

**From:** publicaccess@rushmoor.gov.uk <publicaccess@rushmoor.gov.uk>  
**Sent:** 19 November 2022 21:54  
**To:** Rushmoor Council Licensing <Licensing@rushmoor.gov.uk>  
**Subject:** Comments for Licensing Application 22/01169/LAPRE

### Comments summary

Dear Sir/Madam,

Licensing Application comments have been made. A summary of the comments is provided below.

Comments were submitted at 19/11/2022 9:53 PM from [REDACTED]

#### Application Summary

Address:	71 High Street Aldershot Hampshire GU11 1BZ
Proposal:	Premises Licence
Case Officer:	Aimee Vosser

[Click for further information](#)

#### Customer Details

Name:	[REDACTED]
Email:	[REDACTED]
Address:	[REDACTED]

#### Comments Details

1

Commenter Type:	Other
Stance:	Customer objects to the Licensing Application
Reasons for comment:	
Comments:	19/11/2022 9:53 PM A lot of people are making noise ,crowding and sometime fighting next to car park. This shop will attract more crime and trouble to public In my opinion they should not open till late night . Thankyou!

Kind regards

## APPENDIX C8

**From:** publicaccess@rushmoor.gov.uk <publicaccess@rushmoor.gov.uk>  
**Sent:** 24 November 2022 12:14  
**To:** Rushmoor Council Licensing <Licensing@rushmoor.gov.uk>  
**Subject:** Comments for Licensing Application 22/01169/LAPRE

### Comments summary

Dear Sir/Madam,

Licensing Application comments have been made. A summary of the comments is provided below.

Comments were submitted at 24/11/2022 12:13 PM from [REDACTED].

#### Application Summary

Address: 71 High Street Aldershot Hampshire GU11 1BZ

Proposal: Premises Licence

Case Officer: Aimee Vosser

[Click for further information](#)

#### Customer Details

Name: [REDACTED]

Email: [REDACTED]

Address: [REDACTED]

#### Comments Details

1

Commenter Type: Petition

Stance: Customer objects to the Licensing Application

Reasons for comment:

Comments: 24/11/2022 12:13 PM It will create so much noise pollution, and will contribute to the crime in Aldershot town.

Kind regards

## APPENDIX D

### RELEVANT CONSIDERATIONS 71 HIGH STREET, ALDERSHOT, HAMPSHIRE GU11 1BZ

#### 1.0 Guidance issued under S182 of the Licensing Act 2003 (December 2022)

1.1. The sections of the Secretary of State's guidance identified in **Table 1** below may be relevant to the consideration of this application

**TABLE 1 - SECTIONS OF THE SECRETARY OF STATE'S GUIDANCE  
WHICH MAY BE RELEVANT TO THIS APPLICATION**

Section	Other Ref.	Paragraph(s)		Subject Matter	Page(s)	
		From	To		From	To
<b>2</b>	-	<b>2.1</b>	<b>2.32</b>	<b>The licensing objectives</b>	<b>6</b>	<b>12</b>
2	-	2.1	2.6	Crime and Disorder	6	7
2	-	2.15	2.21	Public Nuisance	9	10
<b>8</b>	-	<b>8.1</b>	<b>8.110</b>	<b>Applications for a premises licence</b>	<b>54</b>	<b>72</b>
<b>9</b>	-	<b>9.1</b>	<b>9.45</b>	<b>Determining applications</b>	<b>73</b>	<b>81</b>
9	-	9.3	9.3	Where representations are made	73	73
9	-	9.31	9.41	Hearings	78	80
<b>10</b>	-	<b>10.1</b>	<b>10.66</b>	<b>Conditions attached to premises licences and club premises certificates</b>	<b>82</b>	<b>93</b>
10	-	10.8	10.9	Imposed conditions	83	83
<b>13</b>	-	<b>13.1</b>	<b>13.13</b>	<b>Appeals</b>	<b>109</b>	<b>111</b>
13	-	13.10	13.11	Giving reasons for decision	110	110

#### 2.0 The Council's Licensing Policy

2.1. The sections of the Council's Licensing policy identified in **Table 2** below may be relevant to the consideration of this application.

**TABLE 2 - SECTIONS OF THE COUNCIL'S LICENSING POLICY  
WHICH MAY BE RELEVANT TO THIS APPLICATION**

Section	Other Ref.	Paragraph(s)		Subject Matter	Page(s)	
		From	To		From	To
<b>3</b>	<b>Part C</b>	<b>3.1</b>	<b>3.43</b>	<b>Licensing principals, objectives &amp; General considerations</b>	<b>13</b>	<b>17</b>
3	Part C	3.10	3.12	General licensing principals	14	14
<b>6</b>	<b>Part F</b>	<b>6.1</b>	<b>6.53</b>	<b>Premises Licences</b>	<b>26</b>	<b>34</b>
<b>18</b>	<b>Part R</b>	<b>18.1</b>	<b>18.55</b>	<b>Representations, Responsible authorities &amp; Interested Parties</b>	<b>69</b>	<b>74</b>
18	Part R	18.45	18.48	The weight attached to relevant representations	73	74
<b>19</b>	<b>Part S</b>	<b>19.1</b>	<b>19.27</b>	<b>Conditions and restrictions</b>	<b>76</b>	<b>79</b>
19	Part S	19.10	19.15	General principles of transposition and imposition of conditions	76	77

**NB:** Matters in **bold** indicate main section headings.